

ROMAN BLIND WITH CORDLOCK INSTALLATION

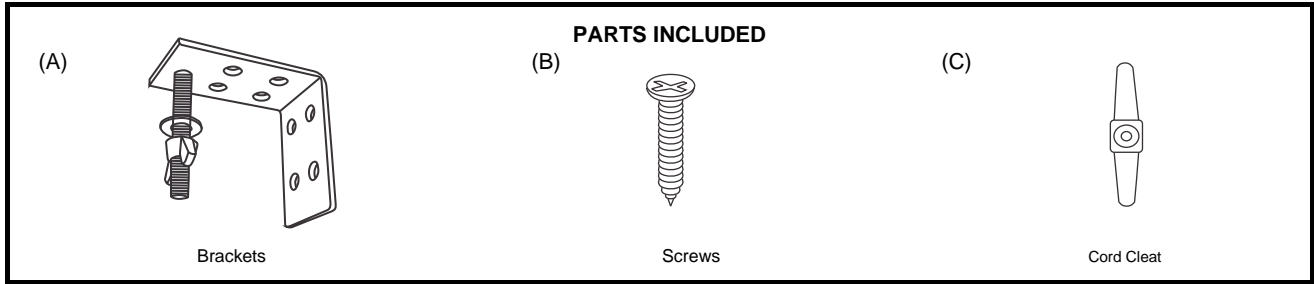

IMPORTANT NOTES:

1. Please check that all parts have been supplied before you begin to assemble your new Roman Blind.
2. The finished blind size is:
 - (i) **OUTSIDE Mount:** as per size ordered.
 - (ii) **INSIDE Mount:** width less 10mm, drop less 20mm
3. Ensure that the blind is mounted level for correct operation.

1. Positioning Blind

As per your order, determine the correct fitting location

- (i) inside the window frame (Inside Mount) or;
- (ii) on the window frame or wall (Outside Mount)

2. Installing Mounting Brackets

Inside Mount:

- (i) The Installation Brackets are fixed directly to the mounting surface, spaced evenly. Make sure all brackets are in a straight line so that the track will attach easily.
- (ii) If possible, mount the first bracket between the control mechanism and the first draw cord for maximum support.

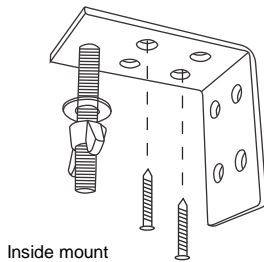

" A Roman Blind may appear short in its drop on initial installation, however over a short period of time, the fabric will settle and sit at the correct drop length. Environmental conditions can also impact on the settling out process."

Outside Mount:

- (i) The Installation Brackets are fixed directly to the architrave or wall, spaced evenly. Make sure all brackets are level.
- (ii) If possible, mount the first bracket between the control mechanism and the first draw cord for maximum support

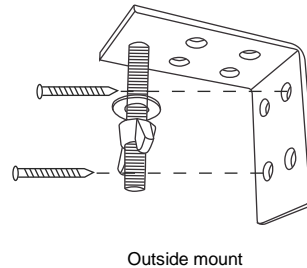

3. Attaching Blind to Bracket

- (i) Make a hole on each left and right side of blind headrail, using screwdriver. The holes are 8 cm wide, so its easily to feel by rubbing headrail bottom.

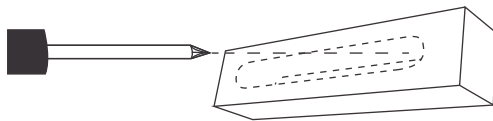

- (ii) Place up the blind headrail into the bracket screw, then tighten the ring and moor.

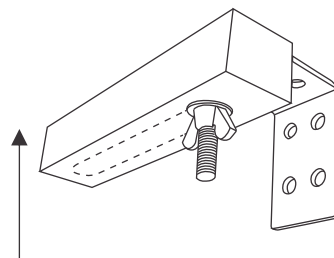

4. Operating Cordlock Roman Blind

To lower the blind:

Pull gently downwards on all the operating cords together (to release the cordlock) then carefully raise the cords to the desired location. With a quick easy downwards motion, the cordlock will lock the cords.

To raise the blind:

Pull gently downwards until the desired location is reached, then with a quick easy upwards motion, the cord lock will lock the blind in that position.

5. Attaching Cord Cleat

Position the cord cleat at a height that is comfortable to use, that will keep the cords out of reach from children and pets.



WARNING - ALL WINDOW COVERINGS WITH CORD OR CHAIN

To avoid creating a possible strangulation hazard for children, the corded or chained internal window covering must be installed in such a way that a loose cord or chain cannot form a loop 220mm or longer at a height of less than 1600mm above floor level.

* A cord/chain guide may be installed lower than 1600mm above floor level if the cord/chain is sufficiently secured or tensioned to prevent a loop 220mm or longer from being formed.

* If a cord/chain guide is installed lower than 1600mm above floor level, it must be designed to prevent a child from being able to remove the cord/chain.

* If a cleat is used to secure the cord, it must be at least 1600mm above floor level because a child is capable of unwinding a cord from a cleat.

Installing Cord Cleat

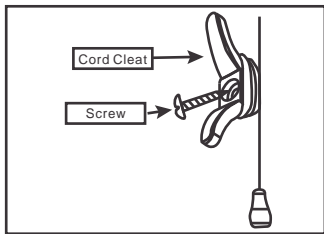

Cord cleats must be installed to comply with Regulations.

The cleats must be installed at least 1600mm above floor level, because a child is capable of unwinding a cord from a cleat.

Fasten the cleats to the wall using the screws provided. Do not use tape or glue to attach the cleats.

Note: the cord must be wrapped around the cord cleat to prevent child strangulation. **The cord must not form a loop longer than 220mm, and should be wound entirely around the cleat.**

Adjust Safety Cord Stop

To reduce the risk of strangulation to infants and toddlers, position safety cord stops before using the blind.

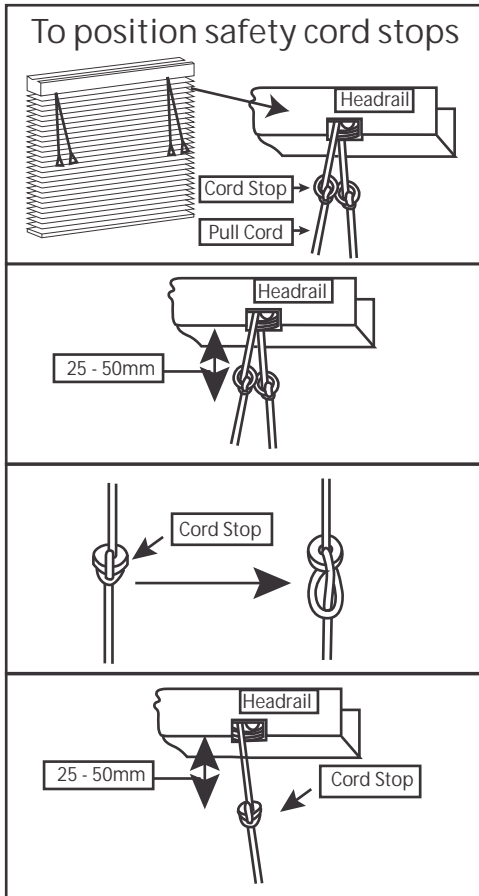

1

Install blind according to the directions provided, making sure the headrail is securely fastened. Lower the blind to the maximum desired length, and lock the cords in place.

2

Measure the distance from the headrail to the cord stops. If the cord stops are 25 to 50mm below the headrail, no further adjustment is needed. Your blind is ready to use.

3

If cord stops ARE NOT 25 to 50mm below the headrail, loosen (but do not untie) the knot surrounding the cord stop.

4

Push both the cord stop and the loosened knot toward the headrail until the cord stop is 25 to 50mm below the headrail. Hold the cord stop in place and pull firmly on the cord to retighten the knot. Repeat steps 2, 3 & 4 for each cord stop.

How to Adjust Pull Cord Length / Reassemble Breakaway Tassel

Our blind comes equipped with a breakaway tassel that prevents child strangulation. Should the breakaway tassel come apart, please refer to Step 4.

NOTE : To reassemble breakaway tassel refer to Step 4, otherwise proceed with Step 1 to adjust pull cord lengths.

1. After determining desired height of breakaway tassel, open breakaway tassel.
2. Raise the breakaway tassel to desired height and tie knot to each pull cord end.
NOTE : make sure all pull cord lengths is even before proceeding.
3. Cut excess pull cords, beneath knots, using scissors.
4. Place pull cords into grooves and snap breakaway tassel together to close.

