

ALUMINIUM BLIND INSTALLATION

PARTS INCLUDED

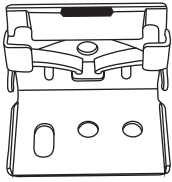

Mounting Brackets

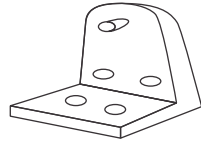

Hold Down Bracket



Installation
Screws



Cord Cleat
Screws



Cord Cleat
(compulsory)



Safety Cord Stop
(supplied on cord)

IMPORTANT NOTES:

1. Please check that all parts have been supplied before you begin to assemble your new Custom Venetian Blind.
2. Ensure that the blind is mounted level for correct operation.

To the wall or front of the window frame

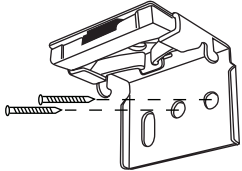

1. Position the end brackets for fixing (either face or top) ensuring that the brackets are fixed approximately 50mm from the end of the blind. The centre bracket (required for blinds exceeding 1200mm width) may be positioned as required.

To the ceiling or top of the window frame

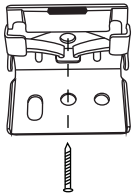

NB: Make sure not to position the brackets where they would interfere with the working mechanisms of the blind.

2. Position the front edge of the track into the front hooks of the installation bracket and gently push upwards and the track will “snap” into position.

To Operate The Blind

Important – always tilt the slats horizontally before raising or lowering the blind.
This will extend the life of the blind, and makes the movement easier and smoother.

Raising: Pull the cord downward until the blind reaches the desired height; release the cord, and the blind will lock automatically.

Lowering: Hold the cord at eye level and move it to the left, pulling down gently until the cord lock releases. Allow the cord to pass through until the blind reaches the desired level. Move the cord to the right and release, and the blind will lock automatically.

Tilting: Rotate the wand on the blind in either direction to attain desired slat position

WARNING!

Blinds must be fitted with safety devices provided to comply with legal requirements. Please turn over leaflet for instructions to fit safety devices.



WARNING - ALL WINDOW COVERINGS WITH CORD OR CHAIN

To avoid creating a possible strangulation hazard for children, the corded or chained internal window covering must be installed in such a way that a loose cord or chain cannot form a loop 220mm or longer at a height of less than 1600mm above floor level.

- * A cord/chain guide may be installed lower than 1600mm above floor level if the cord/chain is sufficiently secured or tensioned to prevent a loop 220mm or longer from being formed.
- * If a cord/chain guide is installed lower than 1600mm above floor level, it must be designed to prevent a child from being able to remove the cord/chain.
- * If a cleat is used to secure the cord, it must be at least 1600mm above floor level because a child is capable of unwinding a cord from a cleat.

Installing Cord Cleat

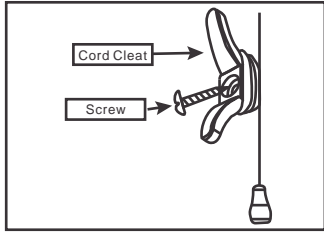

Cord cleats must be installed to comply with Regulations.

The cleats must be installed at least 1600mm above floor level, because a child is capable of unwinding a cord from a cleat.

Fasten the cleats to the wall using the screws provided. Do not use tape or glue to attach the cleats.

Note: the cord must be wrapped around the cord cleat to prevent child strangulation. **The cord must not form a loop longer than 220mm, and should be wound entirely around the cleat.**

Installing Hold Down Bracket

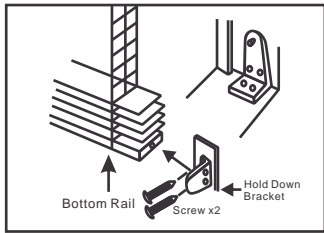

The use of hold down brackets is recommended for additional child safety, but is not a requirement for the normal functioning of the blind.

Using the two screws provided, attach the base of the hold down bracket to the window facing or sill. Additional fixing can also be fitted through the side of the bracket (where suitable). Snap bracket pin ends into the holes in the ends of the bottom rail.

Adjust Safety Cord Stop

To reduce the risk of strangulation to infants and toddlers, position safety cord stops before using the blind.

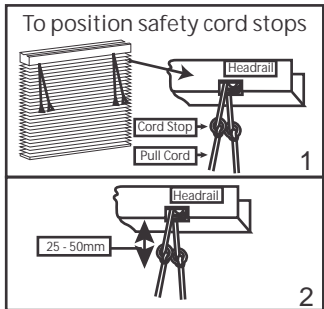

Install blind according to the directions provided, making sure the headrail is securely fastened. Lower the blind to the maximum desired length, and lock the cords in place.

Measure the distance from the headrail to the cord stops. If the cord stops are 25 to 50mm below the headrail, no further adjustment is needed. Your blind is ready to use.

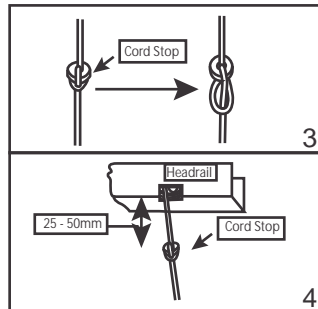

If cord stops ARE NOT 25 to 50mm below the headrail, loosen (but do not untie) the knot surrounding the cord stop.

Push both the cord stop and the loosened knot toward the headrail until the cord stop is 25 to 50mm below the headrail. Hold the cord stop in place and pull firmly on the cord to retighten the knot. Repeat steps 2, 3 & 4 for each cord stop.

How to Adjust Pull Cord Length / Reassemble Breakaway Tassel

Our blind comes equipped with a breakaway tassel that prevents child strangulation. Should the breakaway tassel come apart, please refer to Step 4.

NOTE : To reassemble breakaway tassel refer to Step 4, otherwise proceed with Step 1 to adjust pull cord lengths.

1. After determining desired height of breakaway tassel, open breakaway tassel.
2. Raise the breakaway tassel to desired height and tie knot to each pull cord end.
NOTE : make sure all pull cord lengths is even before proceeding.
3. Cut excess pull cords, beneath knots, using scissors.
4. Place pull cords into grooves and snap breakaway tassel together to close.

